

85x120mm

封面250克哑膜 内页128克双铜

骑马订

PROJECTOR × **uhaleOS**

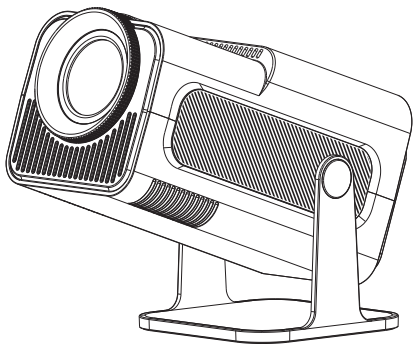

Smart Projector

※ Quick Installation Guide ※

NETFLIX

 **YouTube**

Disney+

prime video

Attention

Please read this manual carefully before use and keep it for future reference.

- 1.The projector is non dustproof or waterproof.
- 2.In order to reduce the risk of fire and electric shock, do not expose the projector to rain and fog.
- 3.Please use the original power adapter. The projector should work under specified rated power supply.
- 4.When projector is working, please do not look directly into the lens, the strong light will flash your eyes and cause slight pain. Children should use the projector under the supervision of adults.
- 5.Do not cover the vents of projector. Heating will reduce the life of projector and cause danger.
- 6.Regularly clean projector vents, or dust may cause cooling malfunction.
- 7.Do not use the projector in greasy, damp, dusty or smoky environment. Oil or chemicals will cause malfunction.
- 8.Please handle with care during daily use.
- 9.Please cut off the power if the projector is out of use for long time.
- 10.Non-professionals are forbidden to disassemble the projector for testing and maintenance.

Structure description

This manual is for reference only. It is subject to change without prior notice. Hotack reserves the right of final interpretation.

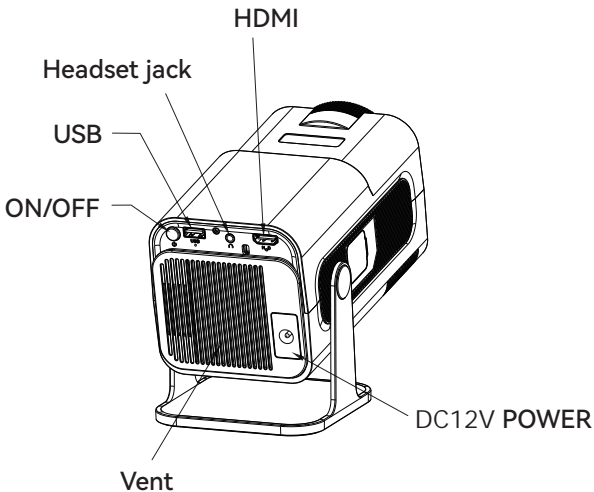

Focus Wheel

Lens

Air inlet

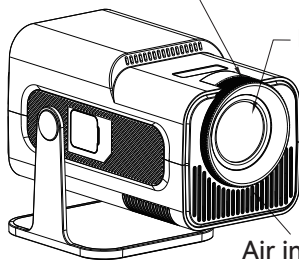

ROTATE

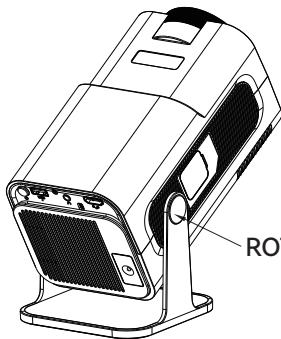

Remote Component and Functions

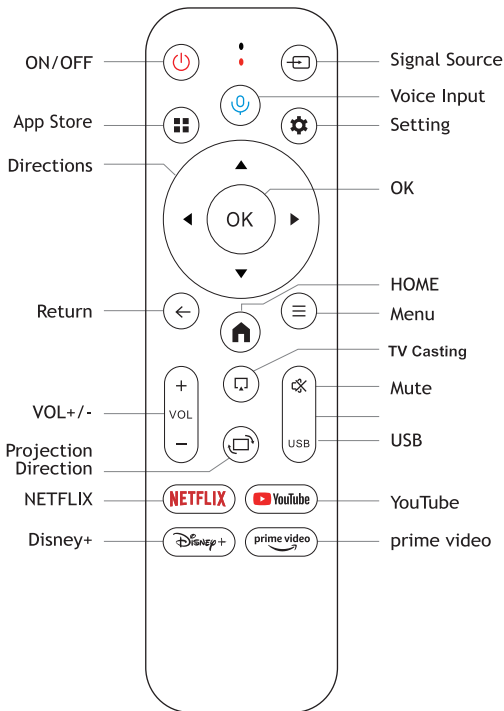

Bluetooth remote controller pairing

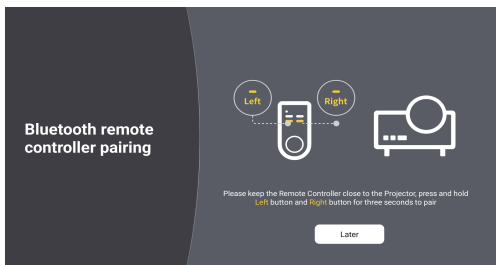

Note: the matching interface of Bluetooth remote control, Press "Voice input" button to bring up the matching guide.

Select or add a Wi-Fi network



Privacy Policy

Smart Projector TOU

[Privacy Policy](#)

[Update Notice](#)

[TERMS OF USE](#)

[HaseoTV Data Privacy Statement](#)

☐ Weather Information

☐ Statistics to help us improve

☐ Parental Control Selection for 18+ Rated...

Contact Us

You can contact us through the After Sales Service. You can contact us if you have any question regarding our privacy policy, and we would like to request a copy of your personal data, or tell us in advance if you want us to change or delete your personal data. You can access more information by viewing our official website.

*Please carefully read the agreement before determining whether to accept or not.

Accept

Select your Language

Select your Language

English

Français

Deutsch

Italiano

Español

...

Feature introduction

Left side

1. Weather.
2. Setting.
3. Signal.
4. Recently viewed.
5. Search.

The right side is the application area, where all applications installed by the user will be displayed here, with no limit on the number. The first eight application positions are preset applications. Cannot be moved and cannot be removed. Applications installed by users start from the ninth position.

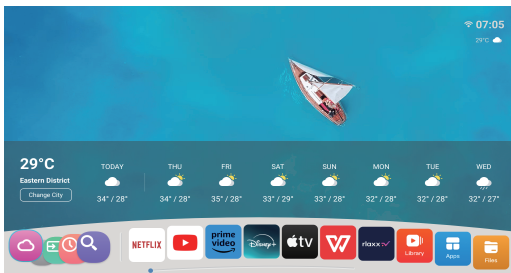



Weather:

By default, the climate and temperature of the current city on the 7th this week are displayed. Change City can switch city display.



Signal:

After connecting projector to other output device, enter HD.



Recently viewed:

Record what users watch and use the App.



Search:

global search function.



Application download.
Application installation.



The file manager has the ability to select, compile, sort, and display lists and thumbnails.

WIFI & Bluetooth

⚙ Setting-Wireless and Network: WIFI & wired network connection and Bluetooth related functions.

Wireless and Network	Wired or Wi-Fi
	Connect to Network
	Wi-Fi On/Off
	View network info
	Network configuration
	Clear Internet memory
	Bluetooth
	Search for Bluetooth device
	Bluetooth On/Off
	Remove Bluetooth device

Image Settings

⚙ Setting-Picture: Image settings.

Picture	Personalized Picture Settings
	Picture Mode
	Eye Protection Mode
	Nosie Reduction
	DLC

Sound Settings

⚙ Setting-Sound: Sound Settings.

Sound	Balance
	Sound Mode
	Audio Output Devices
	Select formats
	AVC
	Surround

Lens Settings

⚙ Setting-Lens: Projection Direction、Autofocus Settings、Keystone Correction、Digital Zoom.

Lens	Projection direction
	Autofocus settings
	Keystone correction
	Digital zoom

Device preference

- ⚙️ Setting-Device Preference: Device preference settings include TV time, language, keyboard, about device and other settings.

Device Preference	Language
	Date & Time
	Keyboard
	Screen saver
	Sleep timer
	About
	Factory settings
	Reset Projector
	Restart Projector
	Whale OS Cast

App Setting

- ⚙️ Setting-App Setting: Apps、 Device Preferences.

App setting	Recently opened apps
	View all apps
	App permissions

Voice Service

⚙ Setting-Voice Service: Voice service settings.

Voice service	Language
	Primary Language
	Other Settings
	Timbre
	Skil

Software Update

⚙ Setting-Software Update: Software update includes two methods of Internet USB.

Software Update	System update
	Search for update
	Current Software
	Current software info

Miracast

Ensure that Android devices(phone,pad,ect)are in the same local wireless LAN with these devices.

Operations on Devices:

Setting-Device Preference-Whale OS Cast-Miracast-Click here to open Miracast: Turn on the phone mirroring-Connection.

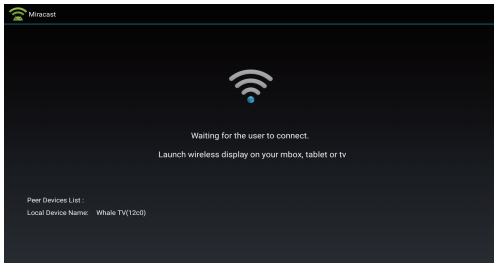

Operations Android phone devices.

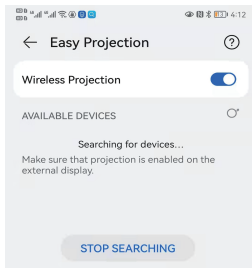

Airplay

Ensure that Apple devices(iphone,pad,ect)are in the same local wireless LAN with these devices.

Operations iphone devices:

Turn on the phone mirroring→Connection.

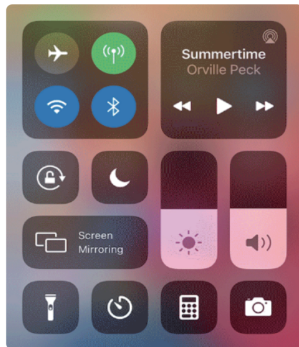

Safety instructions

- Please pay attention to important information related to the operation and maintenance of the projector. You should read this information carefully to avoid problems. Following safety instructions will increase the life of projector.
- Please consult the qualified personnel for installation and repair services, and do not use damaged wires, accessories and other peripherals.
- Projector should be kept away from flammable, explosive, strong electromagnetic interference (large radar stations, power stations, substations) ,etc. Strong ambient light (avoid direct sunlight), etc.
- Do not cover projector vents.
- Please use the original power adapter.
- Keep adequate ventilation and make sure vents are not covered to avoid projector overheating
- When projector is working, please do not look directly into the lens, the strong light will flash your eyes and cause slight pain.
- Do not bend or drag the power cord.
- Do not put power cord under projector or any heavy objects.
- Do not cover other soft materials on power cord.
- Do not heat the power cord.
- Avoid touching power adaptor with wet hands.

Disclaim

This manual is general instructions, The pictures and functions in this manual should subject to the actual product. Our company is devoting to improve product performance, we reserve the right to modify product functions and interface described in this manual without notice.

Please keep your device properly. We are not responsible for any loss caused by wrong operation of software/hardware or repairing or any other reasons. We are not responsible for any loss of any third party claims.

This manual has been carefully checked by professional engineer, please understand for any inevitable omissions.

FCC Statement

1.This device complies with Part 15 of the FCC Rules.
Operation is subject to the following two conditions:

- (1)This device may not cause harmful interference.
- (2)This device must accept any interference received, including interference that may cause undesired operation.

2.Changes or modifications not expressly approved by the party responsible for compliance could void the user's authority to operate the equipment.

Note: This equipment has been tested and found to comply with the limits for a class B digital device, pursuant to Part 15 of the FCC Rules. These limits are designed to provide reasonable protection against harmful interference in a residential installation.

This equipment generates uses and can radiate radio frequency energy and, if not installed and used in accordance with the instructions, may cause harmful interference to radio communications. However, there is no guarantee that interference will not occur in a particular installation. If this equipment does cause harmful interference to radio or television reception, which can be determined by turning the equipment off and on, the user is encouraged to try to correct the interference by one or more of the following measures:

- Reorient or relocate the receiving antenna.
- Increase the separation between the equipment and receiver.
- Connect the equipment into an outlet on a circuit different from that to which the receiver is connected.
- Consult the dealer or an experienced radio/TV technician for help.

The device has been evaluated to meet general RF exposure requirement, This equipment should be installed and operated with a minimum distance of 20cm between the radiator and your body.

ISED Statement

English: This device contains licence-exempt transmitter(s)/receiver(s) that comply with Innovation, Science and Economic Development Canada's licence-exempt RSS(s). Operation is subject to the following two conditions:

(1) This device may not cause interference.

(2) This device must accept any interference, including interference that may cause undesired operation of the device.

The digital apparatus complies with Canadian CAN ICES-3 (B)/NMB-3(B).

French: Cet appareil contient des émetteurs/récepteurs exempts de licence qui sont conformes aux RSS exemptés de licence d'Innovation, Sciences et Développement économique Canada.

L'exploitation est soumise aux deux conditions suivantes :

(1) Cet appareil ne doit pas provoquer d'interférences.

(2) Cet appareil doit accepter toute interférence, y compris les interférences susceptibles de provoquer un fonctionnement indésirable de l'appareil.

l'appareil numérique du ciem conforme canadien peut - 3 (b) / nmb - 3 (b).

This device meets the exemption from the routine evaluation limits in section 2.5 of RSS 102 and compliance with RSS 102 RF exposure, users can obtain Canadian Information on RF exposure and compliance.

cet appareil est conforme à l'exemption des limites d'évaluation courante dans la section 2.5 du cnr - 102 et conformité avec rss 102 de l'exposition aux rf, les utilisateurs peuvent obtenir des données canadiennes sur l'exposition aux champs rf et la conformité.

This equipment complies with Canada radiation exposure limits set forth for an uncontrolled environment.

Cet équipement est conforme aux limites d'exposition aux rayonnements du Canada établies pour un environnement non contrôlé.

This equipment should be installed and operated with minimum distance 20cm between the radiator & your body.

Cet équipement doit être installé et utilisé à une distance minimale de 20 cm entre le radiateur et votre corps.



HIGH-DEFINITION MULTIMEDIA INTERFACE

The terms HDMI, HDMI High-Definition Multimedia Interface, HDMI Trade dress and the

HDMI Logos are trademarks or registered trademarks of HDMI Licensing Administrator, Inc.



Attention:

Please do not look directly into the lens when projecting to prevent the strong light doing harm to your eyes. Kids should use the projector under the supervision of adults.

HY320AA221124